

Most Current Owner

Current Owner	Co-Owner	Care Of	Mailing Address
SAVANNAH COLLEGE OF ART & DESIGN			660 DRAYTON ST SAVANNAH GA 31401

Digest Owner (January 1)

Owner	Co-Owner	Address 1	Address 2	City	State	Zip
SAVANNAH COLLEGE OF ART & DESIGN		660 DRAYTON ST		SAVANNAH GA		31401

Parcel

Status	ACTIVE
Parcel ID	20015 07001
Category Code	344 - Office Building
Bill #	2927543
Address	115 E YORK ST
Unit # / Suite	
City	SAVANNAH
Zip Code	31401-
Neighborhood	04500.00 - D500 DNTN MLK TO E B
Total Units	
Zoning	D-CBD
Class	E6 - Exempt - Schools
Appeal Status	

Legal Description

Legal Description	LOTS 1 THRU 5 ANSON WD THIRD TYTHING PRB 31P 16 PRB 36P 99
Deed Book	374M
Deed Page	437

Permits

Permit #	Permit Date	Status	Type	Amount
17-03492-BC-6	04/21/2017	Complete	CM - COMMERCIAL	\$1,000.00
13-05234-AL-5	06/26/2013	Complete	AD - ADDITION	\$2,000.00
06-1921B-1	01/08/2007	Complete	CO - CERT OF OCCUP	\$0.00
06-1921B-2	08/31/2006	Complete	RN - RENOVATIONS	\$5,000,000.00
06-0457B-3	02/10/2006	Complete	DM - DEMOLITION	\$10,000.00

Inspection

Inspection Date	Reviewer ID
-----------------	-------------

02/27/2019

06/04/2015

04/26/2010

01/17/2008

NAVANGOR

AYONCE

LALOWRIM

STAFF

Appraised Values

Tax Year	Land	Building	Appraised Total	Reason
2021	955,300	5,951,000	6,906,300	
2020	955,300	5,270,800	6,226,100	
2019	955,300	5,270,800	6,226,100	
2018	955,300	5,174,100	6,129,400	
2017	955,300	5,108,900	6,064,200	
2016	955,300	5,068,600	6,023,900	
2015	955,300	5,021,500	5,976,800	
2014	1,647,000	5,458,900	7,105,900	
2013	1,647,000	6,780,000	8,427,000	
2012	1,473,447	5,444,143	6,917,590	

Sales

Sale Date	Sale Price	Sale Validity	Instrument	Book - Page	Grantor	Grantee
12/28/2011	6,917,590	Q	WD	374M - 437	MARINE HOSPITAL LLC	SAVANNAH COLLEGE OF ART & DESIGN
06/29/2005	2,750,000	Q	WD	290K - 0690	URBAN HEALTH CENTER of SA	MARINE HOSPITAL LLC
09/07/1977	0	U	QC	109F - 0488	UNITED STATES of AMERICA	URBAN HEALTH CENTER of SA

Land

Line Number	1
Land Type	S - SQUARE FOOT
Land Code	O2 - OFFICE 2
Square Feet	27,450
Acres	.6302
Influence Factor 1	-60
Influence Reason 1	
Influence Factor 2	
Influence Reason 2	

OBY

Card #	Description	Year Built:	Grade:	Units:	Override:	Area:
1	1243 : CANOPY, WOOD FRAME, LIGHT FALSE MANSARD	2003	1			432
1	9105 : PAVING, CONCRETE	2003	1			4,500

Commercial Building

Card	1
Actual Year Built	1906
Effective Year Built	2002
Percent Complete	100
Main Occupancy	344 : Office Building
Quality / Condition	3 / A-AVERAGE
Units	
Total Area	46,227
Basement Area	732
Finished Basement Area	No

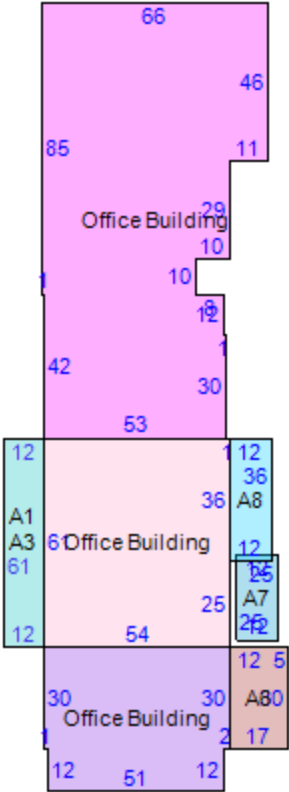

Item	Area
Office Building - 344:Office Building	732
- 9105:PAVING, CONCRETE	4500
Office Building - 344:Office Building	7295
- 1243:CANOPY, WOOD FRAME, LIGHT FALSE MANSARD	432
Office Building - 344:Office Building	732
Office Building - 344:Office Building	3294
Office Building - 344:Office Building	2232
Office Building - 344:Office Building	510
Office Building - 344:Office Building	300

