

Most Current Owner

Current Owner	Co-Owner	Care Of	Mailing Address
SAVANNAH COLLEGE OF ART & DESIGN			26 W HARRIS ST SAVANNAH GA 31401-4354

Digest Owner (January 1)

Owner	Co-Owner	Address 1	Address 2	City	State	Zip
SAVANNAH COLLEGE OF ART & DESIGN		26 W HARRIS ST		SAVANNAH GA		31401

Parcel

Status	ACTIVE
Parcel ID	20031 47008
Category Code	7300 - School (Public,St,T)
Bill #	2983231
Address	229 MARTIN LUTHER KING BLVD
Unit # / Suite	
City	SAVANNAH
Zip Code	31401-
Neighborhood	04500.00 - D500 DNTN MLK TO E B
Total Units	
Zoning	D-X
Class	E6 - Exempt - Schools
Appeal Status	

Legal Description

Legal Description	PARCEL 2 RECOMBINATION OF PARCELS A THRU C AND PT D RAILROAD WD PRB 45P 11 1.76ac
Deed Book	
Deed Page	

Permits

Permit #	Permit Date	Status	Type	Amount
20-00948-BC	03/27/2020	Complete	RN - RENOVATIONS	\$5,256,960.00
19-06035-BC-1	01/17/2020	Complete	CC - CERTIF OF COMP	
19-10401-BC	12/04/2019	Complete	RN - RENOVATIONS	\$460,000.00
19-08097-BC	09/11/2019	Complete	DM - DEMOLITION	\$20,000.00
19-06035-BC	07/23/2019	Complete	AD - ADDITION	\$100,000.00

Inspection

Inspection Date	Reviewer ID
-----------------	-------------

12/08/2020
12/29/2015
02/03/2011

DEGRAVES
LKWOMACK
LALOWRIM

Appraised Values

Tax Year	Land	Building	Appraised Total	Reason
2021	3,680,000	4,260,400	7,940,400	
2020	3,680,000	4,634,500	8,314,500	
2019	3,680,000	4,634,500	8,314,500	
2018	3,680,000	4,756,400	8,436,400	
2017	3,680,000	4,900,300	8,580,300	
2016	3,680,000	5,076,400	8,756,400	
2015	3,680,000	5,244,100	8,924,100	
2014	1,380,000	5,587,100	6,967,100	
2013	1,380,000	7,274,600	8,654,600	
2012	1,380,000	6,955,800	8,335,800	

Land

Line Number	1
Land Type	S - SQUARE FOOT
Land Code	G1 - GENERAL COMMERCIAL 1
Square Feet	76,666
Acres	1.76
Influence Factor 1	-60
Influence Reason 1	
Influence Factor 2	
Influence Reason 2	

OBY

Card #	Description	Year Built:	Grade:	Units:	Override:	Area:
1	1243 : CANOPY, WOOD FRAME, LIGHT FALSE MANSARD	1985	1			330
1	6201 : PAVING, ASPHALT	1985	1			5,000

Commercial Building

Card	1
Actual Year Built	1985
Effective Year Built	1985
Percent Complete	100
Main Occupancy	368 : Classroom (College)
Quality / Condition	3 / A-AVERAGE
Units	
Total Area	70,959
Basement Area	
Finished Basement Area	No

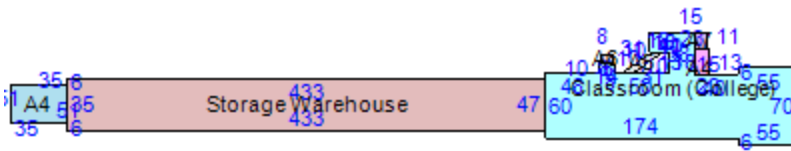

Item	Area
Classroom (College) - 356:Classroom (College)	15438
- 6201:PAVING, ASPHALT	5000
- 1243:CANOPY, WOOD FRAME, LIGHT FALSE MANSARD	330
Classroom (College) - 356:Classroom (College)	299
Classroom (College) - 356:Classroom (College)	180
Classroom (College) - 356:Classroom (College)	80
Classroom (College) - 356:Classroom (College)	165
Storage Warehouse - 406:Storage Warehouse	20351
Storage Warehouse - 406:Storage Warehouse	1785



Sorry, no photo available
for this record

