

PARID: 20003 06002  
532 INDIAN STREET, LLC

532 INDIAN ST

### Most Current Owner

Current Owner	Co-Owner	Care Of	Mailing Address
532 INDIAN STREET, LLC			427 BULL ST SAVANNAH GA 31401

### Digest Owner (January 1)

Owner	Co-Owner	Address 1	Address 2	City	State	Zip
532 INDIAN STREET, LLC		427 BULL ST		SAVANNAH	GA	31401

### Parcel

Status	ACTIVE
Parcel ID	20003 06002
Category Code	7300 - School (Public,St,T)
Bill #	2918729
Address	532 INDIAN ST
Unit # / Suite	
City	SAVANNAH
Zip Code	31401-
Neighborhood	04500.00 - D500 DNTN MLK TO E B
Total Units	
Zoning	D-CBD
Class	C3 - Commercial Lots
Appeal Status	

### Legal Description

Legal Description	PT WHARF LOT 3 N OGLETHORPE WD
Deed Book	2924
Deed Page	0626

### Permits

Permit #	Permit Date	Status	Type	Amount
22-10687-MC	12/02/2022	Issued	HT - HEAT/FURN/HVAC	\$200,000.00
17-05292-BC-18	12/28/2017	Complete	CC - CERTIF OF COMP	\$0.00
17-05292-BC-17	06/19/2017	Complete	RN - RENOVATIONS	\$185,000.00
17-04775 -BC-16	06/02/2017	Complete	DM - DEMOLITION	\$15,000.00
16-10068-BC-15	11/17/2016	Complete	RF - ROOF	\$44,800.00

### Inspection

Inspection Date	Reviewer ID
08/23/2022	PSMILLER

03/28/2019	JCRAWFORD
11/18/2015	LKWOMACK
12/18/2012	DLMARTIN
02/23/2012	DLMARTIN

**Appraised Values**

Tax Year	Land	Building	Appraised Total	Reason
2023	2,671,700	4,655,800	7,327,500	
2022	2,671,700	3,995,800	6,667,500	
2021	2,671,700	3,543,000	6,214,700	
2020	2,671,700	3,615,900	6,287,600	
2019	2,871,000	3,269,700	6,140,700	
2018	1,690,920	3,401,600	5,092,520	
2017	1,690,920	3,401,600	5,092,520	
2016	1,690,920	3,401,600	5,092,520	
2015	220,000	3,671,400	3,891,400	
2014	220,000	3,671,400	3,891,400	

**Sales**

Sale Date	Sale Price	Sale Validity	Instrument Book - Page	Grantor	Grantee
07/13/2022	0	U	GD 2924 - 0626	JOHN MOREL ADLER AKA JOHN M. ADLER AND J	532 INDIAN STREET, LLC
12/26/1992	0	U	NA 158O - 0569	EMMA MOREL ADLER	J. ADLER & H. WILLIAMSON

**Land**

Line Number	1
Land Type	S - SQUARE FOOT
Land Code	G2 - GENERAL COMMERCIAL 2
Square Feet	40,946
Acres	.94
Influence Factor 1	-25
Influence Reason 1	
Influence Factor 2	
Influence Reason 2	

**OBY**

Card #	Description	Year Built:	Grade:	Units:	Override:	Area:
1	6201 : PAVING, ASPHALT	1969		1		16,398
1	9105 : PAVING, CONCRETE	1969		1		2,300

Commercial Building

Card	1
Actual Year Built	1970
Effective Year Built	1995
Percent Complete	100
Main Occupancy	368 : Classroom (College)
Quality / Condition	2 / A-AVERAGE
Units	
Total Area	40,476
Basement Area	
Finished Basement Area	No

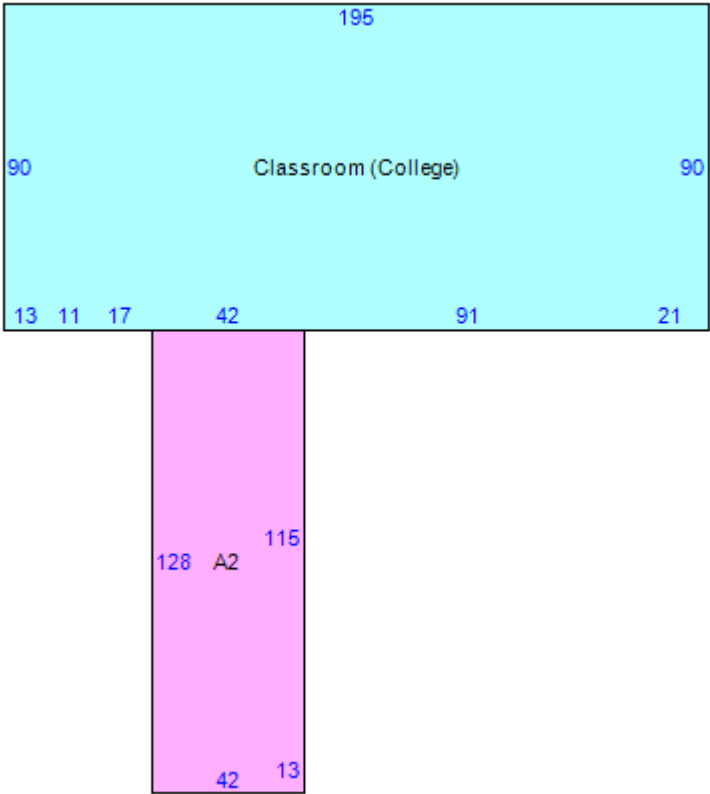

Item	Area
Classroom (College) - 368:Classroom (College)	17550
- 9105:PAVING, CONCRETE	2300
- 683:Wet Sprinklers	
Classroom (College) - 368:Classroom (College)	5376
- 6201:PAVING, ASPHALT	16398
- 651:Passenger #	

