

PARID: 20015 33004B  
CLICK PROPERTIES, LLC

123 LIBERTY ST E

**Most Current Owner**

---

Current Owner	Co-Owner	Care Of	Mailing Address
CLICK PROPERTIES, LLC			818 PRINCE GEORGE PARISH DRIVE MELBOURNE FL 32934

**Digest Owner (January 1)**

---

Owner	Co-Owner	Address 1	Address 2	City	State	Zip
CLICK PROPERTIES, LLC		818 PRINCE GEORGE PARISH DRIVE		MELBOURNE	FL	32934

**Parcel**

---

Status	ACTIVE
Parcel ID	20015 33004B
Category Code	353 - Retail Store
Bill #	2980996
Address	123 E LIBERTY ST
Unit # / Suite	
City	SAVANNAH
Zip Code	31401-
Neighborhood	04500.00 - D500 DNTN MLK TO E B
Total Units	
Zoning	D-N
Class	C3 - Commercial Lots
Appeal Status	

**Legal Description**

---

Legal Description	LOT 5B-2 SUB OF LOT 5 LAFAYETTE WD
Deed Book	2977
Deed Page	0241

**Permits**

---

Permit #	Permit Date	Status	Type	Amount
1510856-3	12/04/2015	Complete	PL - PLUMBING	\$3,000.00
94-06924-1	07/15/1994	Complete	RN - RENOVATIONS	\$3,000.00
94-06924-2	07/15/1994	Complete	RN - RENOVATIONS	\$3,000.00

**Inspection**

---

Inspection Date	Reviewer ID
-----------------	-------------

08/24/2022	PSMILLER
03/25/2019	VMMCCUEN
02/01/2016	VMMCCUEN
01/08/2008	JTBOAEN

### Appraised Values

Tax Year	Land	Building	Appraised Total	Reason
2023	95,500	733,000	828,500	INCOME PROPERTY
2022	95,500	510,000	605,500	INCOME PROPERTY
2021	95,500	447,900	543,400	INCOME PROPERTY
2020	95,500	447,900	543,400	INCOME PROPERTY
2019	95,500	447,900	543,400	
2018	95,500	447,900	543,400	
2017	95,500	447,900	543,400	
2016	67,700	509,300	577,000	
2015	67,700	509,300	577,000	
2014	67,700	509,300	577,000	

### Sales

Sale Date	Sale Price	Sale Validity	Instrument Book - Page	Grantor	Grantee
12/06/2022	3,300,000	U	LD 2977 - 0241	ABRAXAS ABERCORN TWO, LLC	CLICK PROPERTIES, LLC
11/13/2013	1,830,526	U	WD 392N - 952	DRYDEN CLAUDE L & LORETTA R	ABRAXAS ABERCORN TWO LLC
12/28/2006	2,100,000	Q	WD 318Z - 661	LIBERTY-ANDERSON HOLDING	DRYDEN CLAUDE L & LORETTA
05/09/2005	1,400,000	Q	WD 287N - 0313	MORGAN CAROLYNE M	LIBERTY-ANDERSON HOLDING
01/15/1999	595,000	Q	WD 200A - 0083	ESTELLE A BRANDT	CAROLYNE M. MORGAN

### Land

Line Number	1
Land Type	S - SQUARE FOOT
Land Code	G1 - GENERAL COMMERCIAL 1
Square Feet	1,990
Acres	.0457
Influence Factor 1	-60
Influence Reason 1	
Influence Factor 2	
Influence Reason 2	

### OBY

Card #	Description	Year Built:	Grade:	Units:	Override:	Area:
1	1243 : CANOPY, WOOD FRAME, LIGHT FALSE MANSARD	2005		1		16
1	1243 : CANOPY, WOOD FRAME, LIGHT FALSE MANSARD	2005		1		78

**Commercial Building**

Card	1
Actual Year Built	1871
Effective Year Built	2005
Percent Complete	100
Main Occupancy	353 : Retail Store
Quality / Condition	3 / A-AVERAGE
Units	
Total Area	1,236
Basement Area	
Finished Basement Area	No

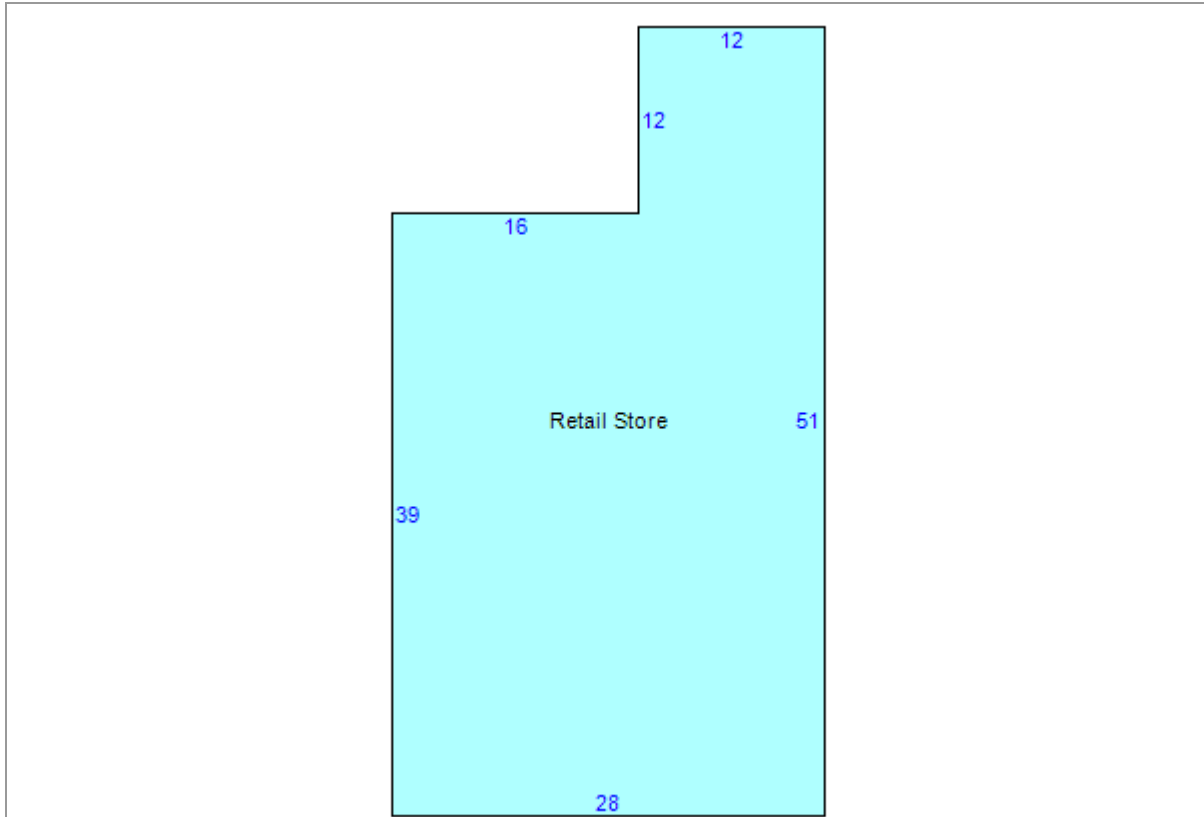

Item	Area
Retail Store - 353:Retail Store	1236
- 1243:CANOPY, WOOD FRAME, LIGHT FALSE MANSARD	78
- 1243:CANOPY, WOOD FRAME, LIGHT FALSE MANSARD	16

