

PARID: 20044 35006

SAVANNAH COLLEGE OF ART & DESIGN

1220 BARNARD ST

Most Current Owner

Current Owner	Co-Owner	Care Of	Mailing Address
SAVANNAH COLLEGE OF ART & DESIGN			26 W HARRIS ST SAVANNAH GA 31401-4354

Digest Owner (January 1)

Owner	Co-Owner	Address 1	Address 2	City	State	Zip
SAVANNAH COLLEGE OF ART & DESIGN		26 W HARRIS ST		SAVANNAH GA		31401

Parcel

Status	ACTIVE
Parcel ID	20044 35006
Category Code	350 - Restaurant
Bill #	3022648
Address	1220 BARNARD ST
Unit # / Suite	
City	SAVANNAH
Zip Code	31401-
Neighborhood	22500.00 - V500 VICTORIAN
Total Units	
Zoning	TC-1
Class	C3 - Commercial Lots
Appeal Status	

Legal Description

Legal Description	LTS 19 21 GALLIE WD
Deed Book	0132X0
Deed Page	

Permits

Permit #	Permit Date	Status	Type	Amount
23-02119-EC	03/09/2023	Issued	-	\$3,500.00
23-01736-PC	02/27/2023	Issued	-	\$500.00
1409230-6	02/06/2015	Complete	CC - CERTIF OF COMP	\$0.00
1409702-5	01/30/2015	Complete	-	\$63,000.00
1409703-4	01/08/2015	Complete	PL - PLUMBING	\$0.00

Inspection

Inspection Date	Reviewer ID
11/09/2021	JCRAWFORD
01/03/2018	VMMCCUEN
07/30/2015	LKWOMACK
04/17/2007	ALCUMMIN

Appraised Values

Tax Year	Land	Building	Appraised Total	Reason
2023	161,300	58,500	219,800	
2022	161,300	50,800	212,100	
2021	161,300	46,900	208,200	
2020	161,300	48,900	210,200	
2019	161,300	48,900	210,200	
2018	131,000	48,600	179,600	
2017	131,000	49,800	180,800	
2016	129,800	52,400	182,200	
2015	129,800	51,400	181,200	
2014	129,800	57,300	187,100	

Sales

Sale Date	Sale Price	Sale Validity	Instrument Book - Page	Grantor	Grantee
12/31/1986	75,000	U	WD 0132X - 0422	KARATASSOS, ELI P. AGT	S.C.A.D.
01/11/1984	27,600	U	NA 0122Q - 0141	BYRD, CAROL	KARATASSOS, ELI P. AGT.
07/03/1972	17,000	U	NA 0100U - 0521	CHATHAM COUNTY	BYRD, CAROL

Land

Line Number	1
Land Type	S - SQUARE FOOT
Land Code	G3 - GENERAL COMMERCIAL 3
Square Feet	12,600
Acres	.2893
Influence Factor 1	-20
Influence Reason 1	
Influence Factor 2	
Influence Reason 2	

OBY

Card # Description Year Built: Grade: Units: Override: Area:

1	1722 : BUILDING, CONCRETE FLOOR, PLAIN	2015	1	352
1	9105 : PAVING, CONCRETE	1999	1	5,600
1	6201 : PAVING, ASPHALT	1999	1	6,600
1	1011 : CANOPY, WOOD FRAME	1975	1	192

Commercial Building

Card	1
Actual Year Built	1938
Effective Year Built	1985
Percent Complete	100
Main Occupancy	350 : Restaurant
Quality / Condition	3 / A-AVERAGE
Units	
Total Area	945
Basement Area	
Finished Basement Area	No

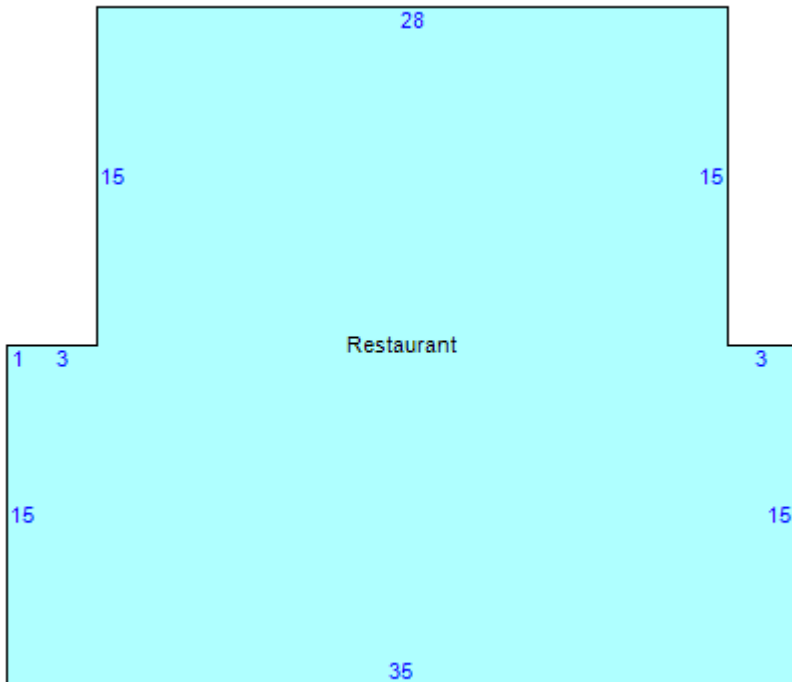

Item	Area
Restaurant - 350:Restaurant	945
- 1722:BUILDING, CONCRETE FLOOR, PLAIN	352
- 9105:PAVING, CONCRETE	5600
- 6201:PAVING, ASPHALT	6600

